

\*



.( 644-634/ 24-13)

. 1136

-589)

( 1193-1171/ 589-567)

1210/ 607

( 1235-1193/ 615

1380/ 782

( 1381-1376- 783-778)

.2014/3/24 :

**.2015 :**

: :

.2013/4/17 :

---

\*

©

---

## **Two New Arabic Ayyubid and Mamluk Inscriptions from the Omari Mosque in AL-karak.**

### **Abstract**

This paper sheds light on the city of al-Karak with regard to its location, toponym, and establishment with main focus on the Omari congregational mosque that is positioned in the middle of the city. The mosque was built during the reign of Omar Bin al-Khattab (13-24 AH\634-644 AD). The Omari mosque played a fundamental role during the subsequent periods up until the crusader occupation of the region in 1136 AD. After Salah al-Deen al Ayoubi (r. 589-567 AH\1171-1193 AD) regained the city from the crusaders, he allotted it to his brother al Malik al-Adel Abu Bakar Bin Ayub (615-589 AH\1193-1235 AD) who rebuilt the Omari Mosque in 607 AH\1210 AD. An inscription commemorating this restoration was set up between the two nave entrances in the north side of the mosque. This inscription was the subject of a historical\ archaeological study herein. As well, a full description of the architectural elements of the mosque supplemented by architectural illustration is provided in this paper. This research concludes that the current mosque was established by al-Malik al-Adel. Another inscription found on top of the former reports that the mosque was rejuvenated by al-Amir Barakah ibn Abdullah al-Jaubani Zainuldin in 782 AH\1380 AD during the reign of Mamluk Sultan al-Mansur Aladdin Ali (778-783 AH\ 1376-1381 AD). This architectural activity of Amir Barakah ibn Abdullah in al-Karak is not mentioned in any of the known textual resources. The results of this research are given in the conclusion.

**Keywords** Al-Karak, al-Omari Mosque, al Malik al Adel, al-Amir al-Ashraf al-Zaini Barakah ibn Abdullah, Ayyubid Period, Mamluk Period.

120  
(1 ) 960  
" "  
(.51-45 1980 159 2008 )  
)  
48 1127 16 1 15 8 25  
(.42 1892 ) . (.21



(1)

( 1450-1482)

Harkur  
(.266 2010 ) . . 1270  
1868 . 850

:

161 2008 142 2009 )  
 (.51-19 1970  
 (. 550-612) (. 612-800)  
 (. . 331-549)  
 " "

1974 66-61 2009 ) ( )  
 .(104

106  
 .(68 2009 )

.(30 1990 ) Charah-Moba

" "

† 629/ 8 10  
 ( 634-632/ 13-11)

636/ 15

: †

1 : 1995 : .488-487 : :1996 : )  
 2 :544-541 : 1 :1994 : .118-114 : 2 :314-312 :  
 .( 236-235 : 3 :353-350 :

.2015

---

( 44-634/ 24-13 )  
.( 100 2 1960 394 3 1967 )

. (408 397-393 1988 ) .

) 1136

. (43 1973

( 1193-1171/ 589-567 )  
1997 ) ‡

.(48-46 4

- 648)

1262/ 661

-1260/ 676-658)

( 1262-1250/ 661

( 1277

1269/ 668

1261/ 659

---

(.423 : : 1984 : 193 : 1990 : ) : ‡

:

---

583 493-492 2 -1 )

.(164-163 1976

1891/ 1309

1994 )

.(19-18

( 2 )

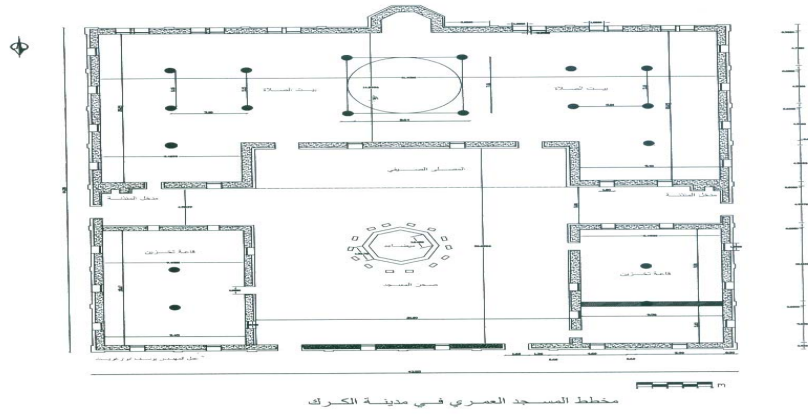

( ) (2)

30 44

( 3 )

10

20

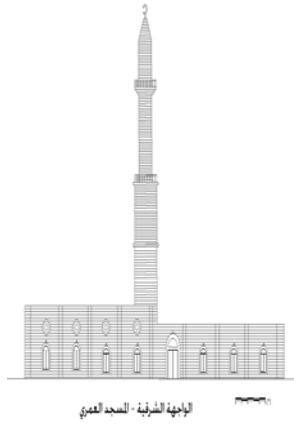



( 4 )



5



4

( 5 )

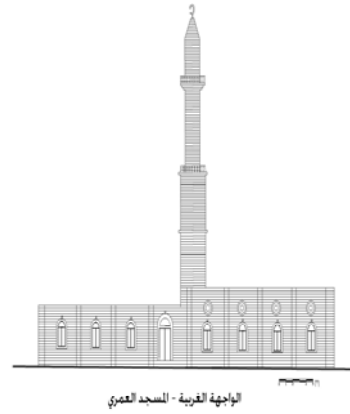
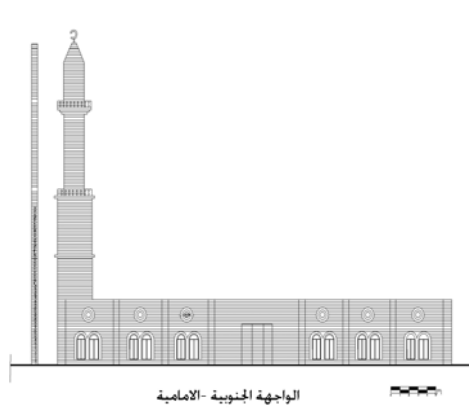

.(

)

(6)



7

( )

:

- - ( )  
89 14×45 41

160

(8 ) .



(8)

110

126

( ) ( 9 10 )



(9)

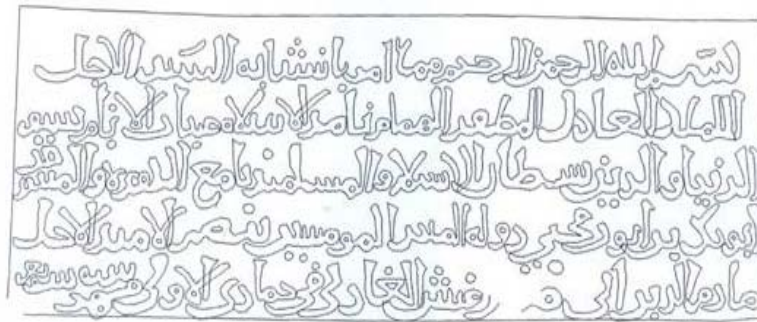

(10)

§

( 328 / 939 )

§

:  
: )

:  
: ( 95 : 9 : 2000 : 1984 : : 286 : 87 : 211 ) .

.2015

---

110×37

-  
-  
-  
-  
-

1145- 540  
( 1174-1146- 569 - 541)  
( 1193-1146- 589-569)  
1186- 582            1183- 579

120-115      22      ) . 1253- 615  
271-270    226-207 26-4            3    1960  
              . (120-115            5

:

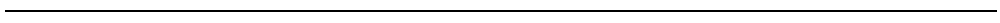

-

( 1986 )



( .(63 1991 )

) .

(

.(59 )

.(206-204 1 2003 )

.( )

)

.(

) ( )

.(23 )

. 960- 349

( ) .(497 1978 ) .

( ) .

.(473 )

( )

( )

( ) .(413 1987 ) .

) .

( ) (10



11 ( )



11

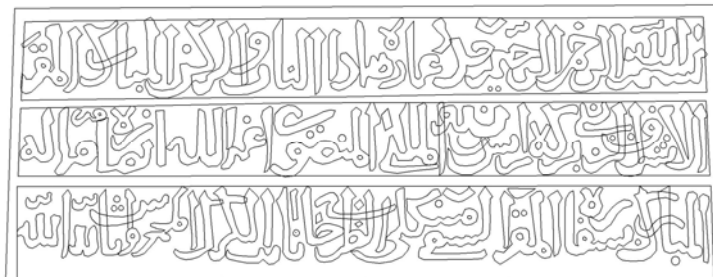

(11)

:

110x37  
( )

-  
-  
-

Compe

1982 (Compe 314 xv11,p tome)

1987 )

(428-427 5 19-18 4  
( 1398-1382- 801-784)

( )

( 1381-1376- 783-778)

1380- 782

.2015

---

660 189 1 1998 51-46 2002 )  
3 1998 166-165 150-141-165 133-129 11 1992  
(135-131

-

-

)

( ) (

.(Ghawanmeh, p10,17) 1366- 768

( )

- -  
1978 )

(447

.(307 263 200 2000 )

:

---

.) (96 ) ( )  
(89 1987 ) ( )  
) ( )  
(80  
( )  
- -  
( )  
( )  
)  
( ) (490-489 161-160 1987  
( ) ( ) ( )  
( )  
)  
( ) ( )

)  
(  
( ) ( )  
( )  
1382- 784 1378- 780  
323 2 1 1974 ) 1393- 796  
(209 395 1 1970 135 3  
(54-53 27 1986 )  
(24 3 1987 )  
1987 )  
(218 2 1970 20 192 4  
. 1261- 659  
( )  
(175 6 )  
( )



. 1136

1210/ 607

:

---

. 1210/ 607

1380/ 782

1 13 ( 892/ 279 )

.1996 1

( 1232/ 630 )

7

. 3 1 1994 1 -



.2015

---

5 ( 1523/ 930 )  
.1974 2 -1  
( 1469/ 874 )  
1  
. 1998 2  
3 6  
. 1985  
16  
.1980 11 1992 1 -  
( 1494/ 900 )  
. 1970 3 3  
( 1468/ 873 )  
.1892  
( 1070/ 463 )  
4  
. 1 1995 1 - -  
( 1292/ 692 )  
.1976 1  
1209/ 606  
.1991  
( 1311/ 711 )  
- 4 15  
.2003 2 -

:

( 1297/ 697 )

3 5

.1960

( 1266/ 665 )

1 4 5

.1997

. 1974 2

4 5 ( 1228/ 626 )

.1990 1

- ( 1494/ 900 )

- . 1984 2

-

22 30 1382/▲748

. 2011 2

3 10 ( 922/ 310 )

. 1967 4

( 1415/ 558 )

. 2002 1

14 ( 1418/ 821 )

. 1987 1 -

3

( 1421/ 824 )

					.2015
	3	3			
			1998		
.1970				2	-3 4
	2		( 897/ 284 )		
					. 1970
					.1978
	9	10			
				2000	-
5					
					.1974
			1994	-	
					. 2008
					. 2010
	1984	-			
. 1990					
	70	69			
					.1973
					.1988

:

---

-

.51-19

1970

15

. 1980

1

. 1988 1

. 2009 5

Combe. J. Sauvaget G.Wiet, Repertoire Chronologique D,Epigraphie, Arabe, Tome xv1,1982.

Ghwanmeh yousef, Earthquakes Effects on Belad El-Sham settlements, Irbid 1990.